

- Notes:**
- This document is the property of Nottingham City Council and may not be used, copied or reproduced in whole or in part in anyway without express prior written consent.
 - Any Ordnance Survey map shown on this drawing is reproduced from Ordnance Survey material with the permission of Ordnance Survey on behalf of the Controller of Her Majesty's Stationery Office © Crown Copyright. Unauthorised reproduction infringes Crown copyright and may lead to prosecution or civil proceedings. Nottingham City Council 100019317 2004.
 - Do not scale from this drawing. All dimensions to be taken from dimensioned drawings only. Dimensions shown are indicative and are to be checked on site prior to the commencement of work or ordering of any materials. Discovery of major discrepancies are to be immediately brought to the attention of the contract administrator.
 - All drawings to be read in conjunction with all other contract documents.
 - Asbestos**
Upon the discovery of any suspect asbestos based materials the contractor shall immediately stop all work and inform the contract administrator and health and safety advisor to confirm what further actions are required. All asbestos materials identified for removal must be removed by an approved licensed contractor. A method statement will be required for these works.

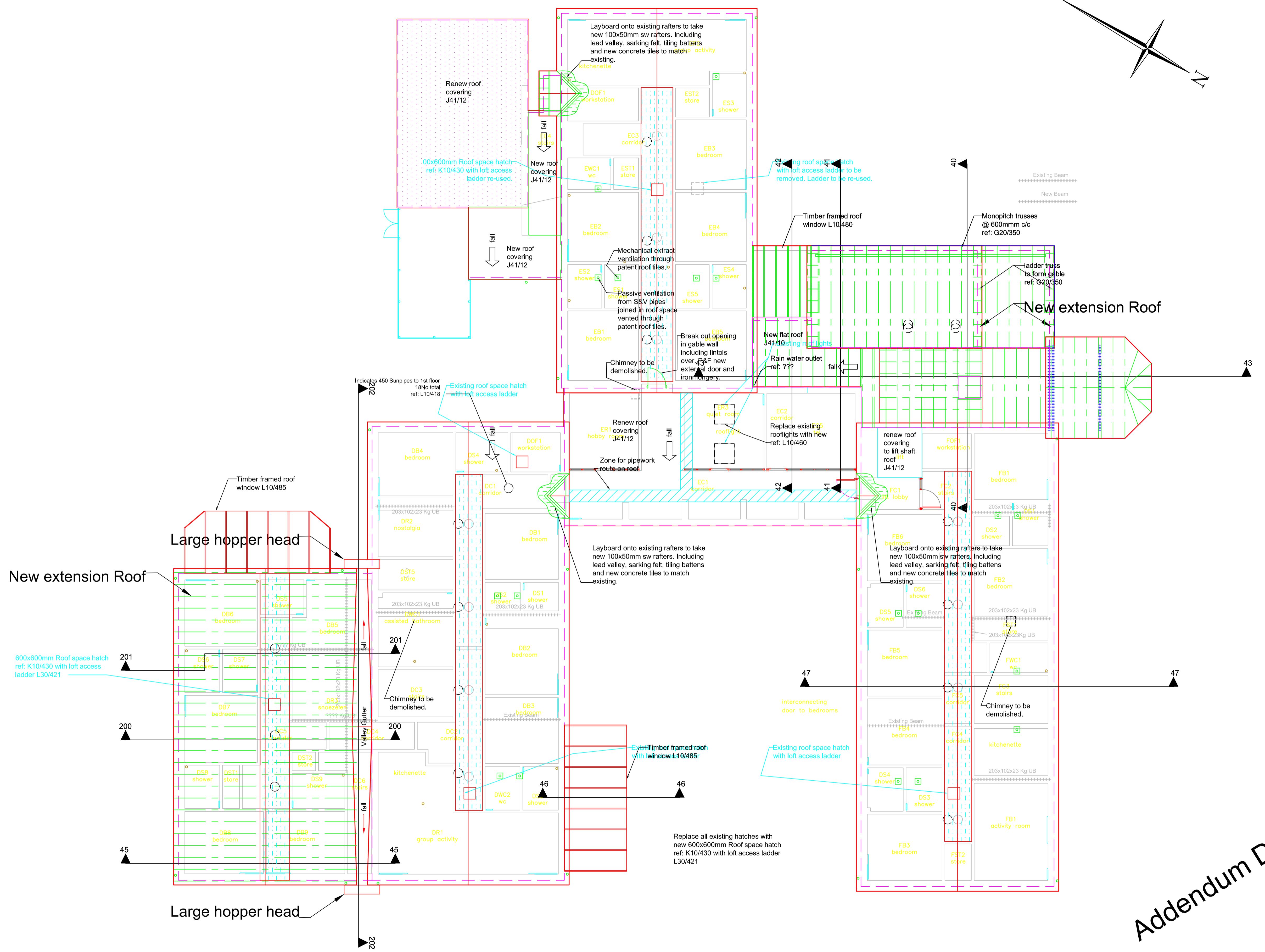
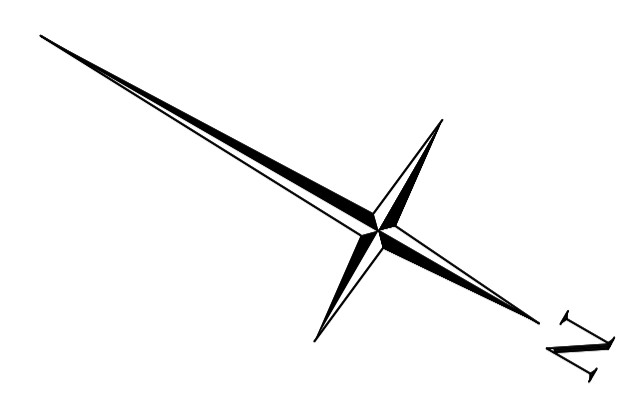

C	Redrawn - extension amended	KNS	GH	16-05-07
B	Replacement hatch note & Fire wall added	KNS	GH	19-02-07
A	Reduced plan			

City of
NOTTINGHAM

Corporate Services
Design and Property
Design Services

Sevens House
20 Middle Pavement
Nottingham
NG1 7DW
Tel. 0115 915 5555
Fax. 0115 915 8156

Project
SS96 Bestwood
Older Persons Home

Title
Proposed Roof Plan Layout

Scale 1:100	Site Code No. (UPRN)	Patch Area Reference	1
Drawn	Checked	Date	

A Drawing No.
SS96/18

A	B	C
---	---	---

Addendum Drg