

All dimensions to be checked on site

All structural information supplied by Structural Engineer (Nottingham office) on Fax dated 13/09/2005.

Structural Engineers Notes:

- New foundations to be 450mm wide, 1200 dp to be checked by Building Control Officer.
- All new walls to be 'Fix' fix starters with debonding sleeves.
- Any assumptions in design to be verified on site.
- All current openings to be blocked up and infilled tight to extents and dry packed.
- Existing basement to be filled with suitable material for foundations (BF2), drain holes to be drilled in existing floor prior to construction.
- Bearings to be checked for adequacy on existing, any doubt, Engineer to be consulted.

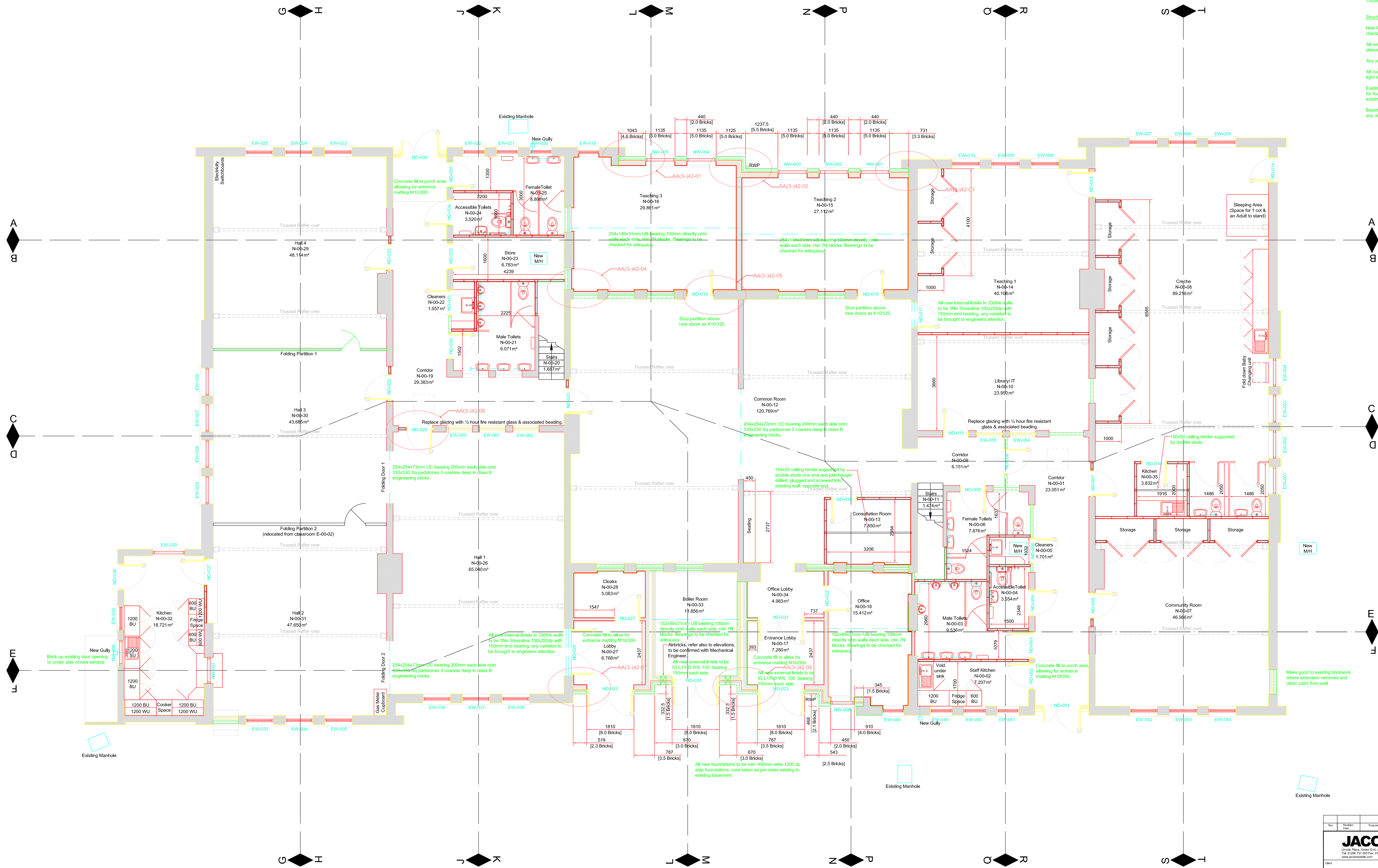

Ground Floor Plan
Scale 1:50

Rev	Description	Purpose of issue	Drawn	Checked	Approved

JACOBS BABTIE
London: 020 7461 1000 Fax: 0208 737 007
www.jacobsbabtie.com

Client: Buckinghamshire County Council

Project: Green Street Youth & Community Centre
Main Block Refurbishment & Extensions

Drawing title: Proposed Ground Floor Plan

Drawing status: TENDER

Scale: 1:50 @ A0
Date: 08/07/07
Client ref:

Drawing number: AL(2)-J022
Rev: 0

This drawing is not to be used in whole or part other than for the intended purpose and project as defined on this drawing. Refer to the contract for full terms and conditions.