

ick

Terrace

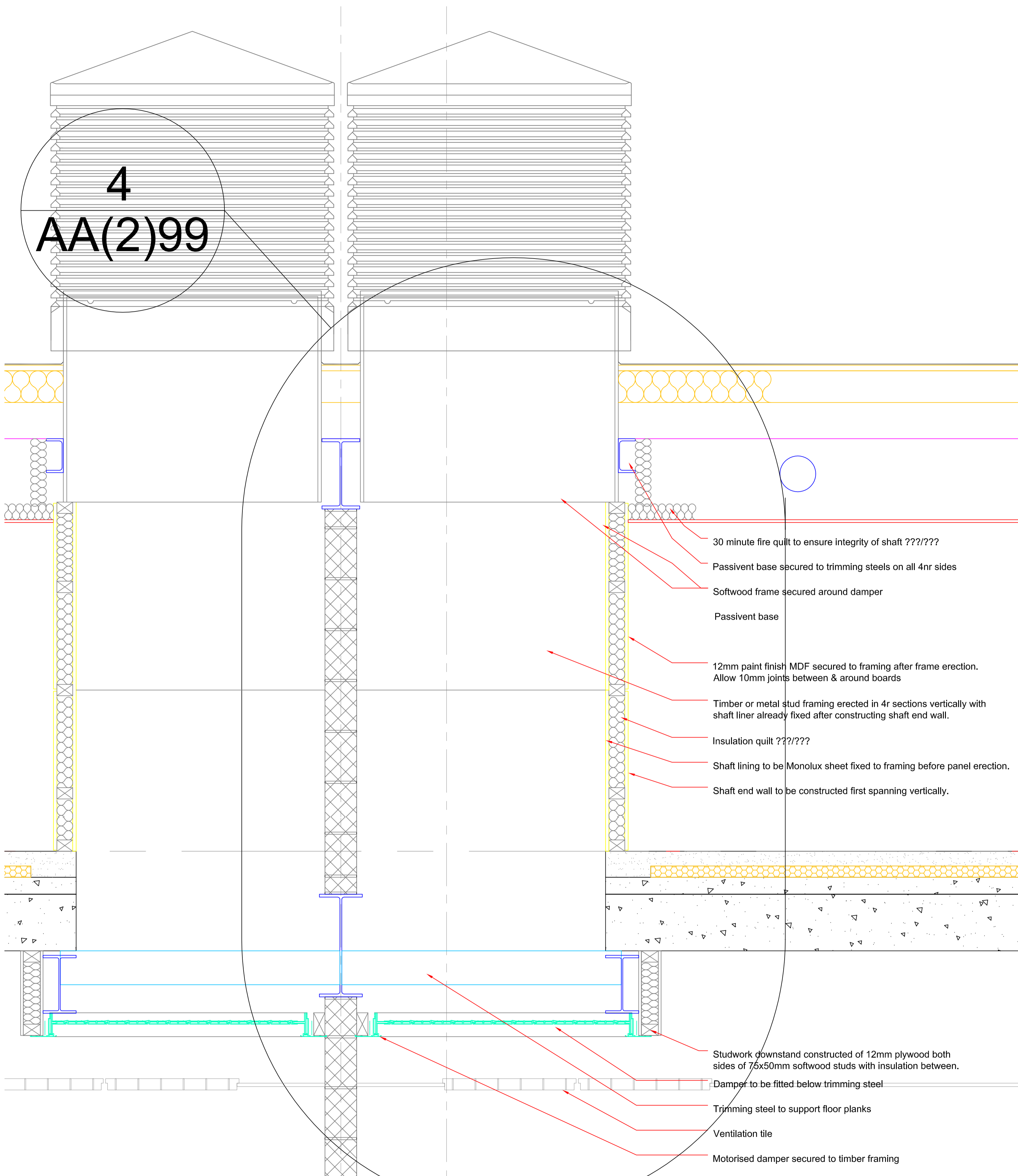

4
AA(2)99

- 30 minute fire quilt to ensure integrity of shaft ???/???
- Passivent base secured to trimming steels on all 4nr sides
- Softwood frame secured around damper
- Passivent base
- 12mm paint finish MDF secured to framing after frame erection. Allow 10mm joints between & around boards
- Timber or metal stud framing erected in 4r sections vertically with shaft liner already fixed after constructing shaft end wall.
- Insulation quilt ???/???
- Shaft lining to be Monolux sheet fixed to framing before panel erection.
- Shaft end wall to be constructed first spanning vertically.

- Studwork downstand constructed of 12mm plywood both sides of 75x50mm softwood studs with insulation between.
- Damper to be fitted below trimming steel
- Trimming steel to support floor planks
- Ventilation tile
- Motorised damper secured to timber framing

1500 high balustrade

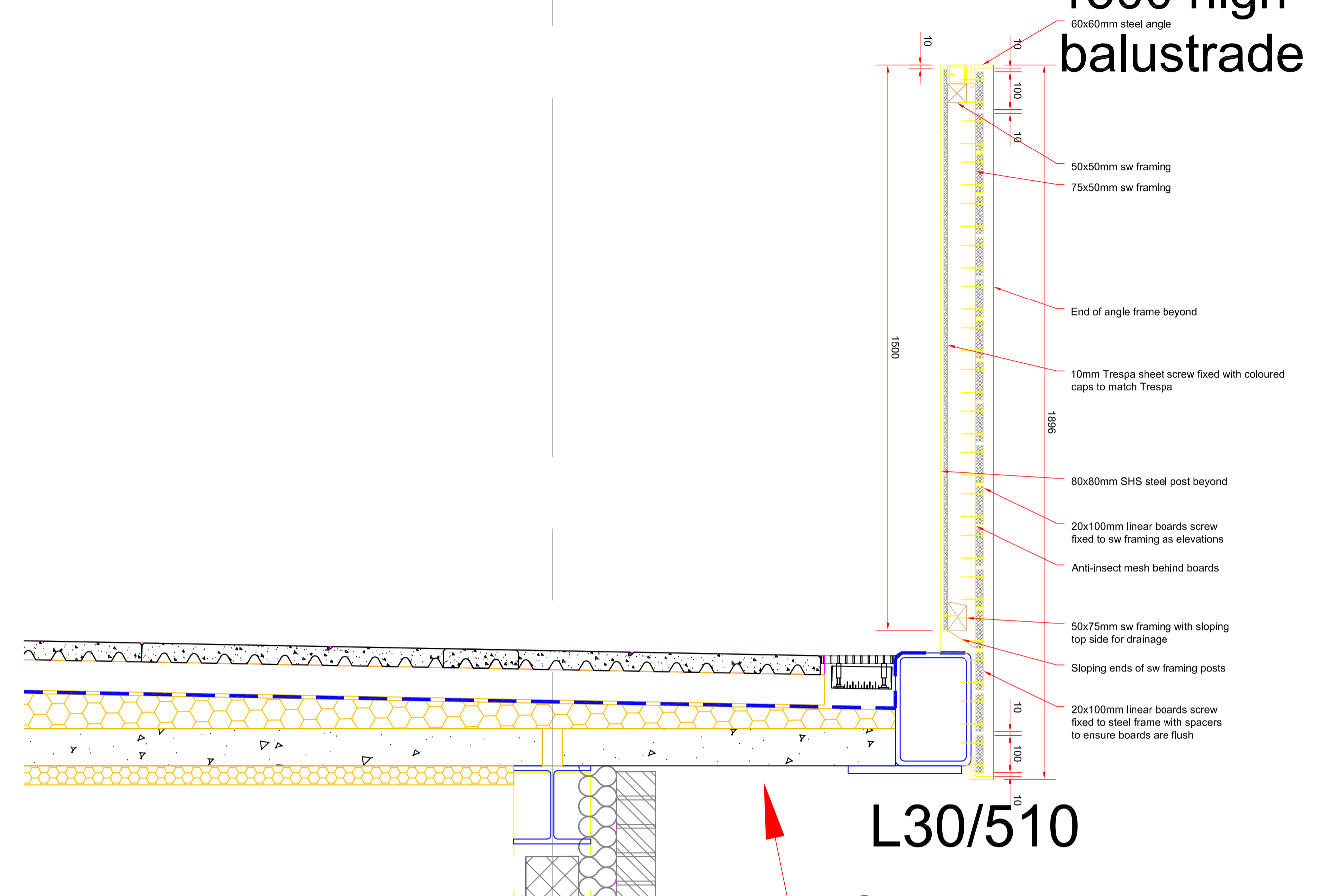

L30/510

1500 high glazed balustrade

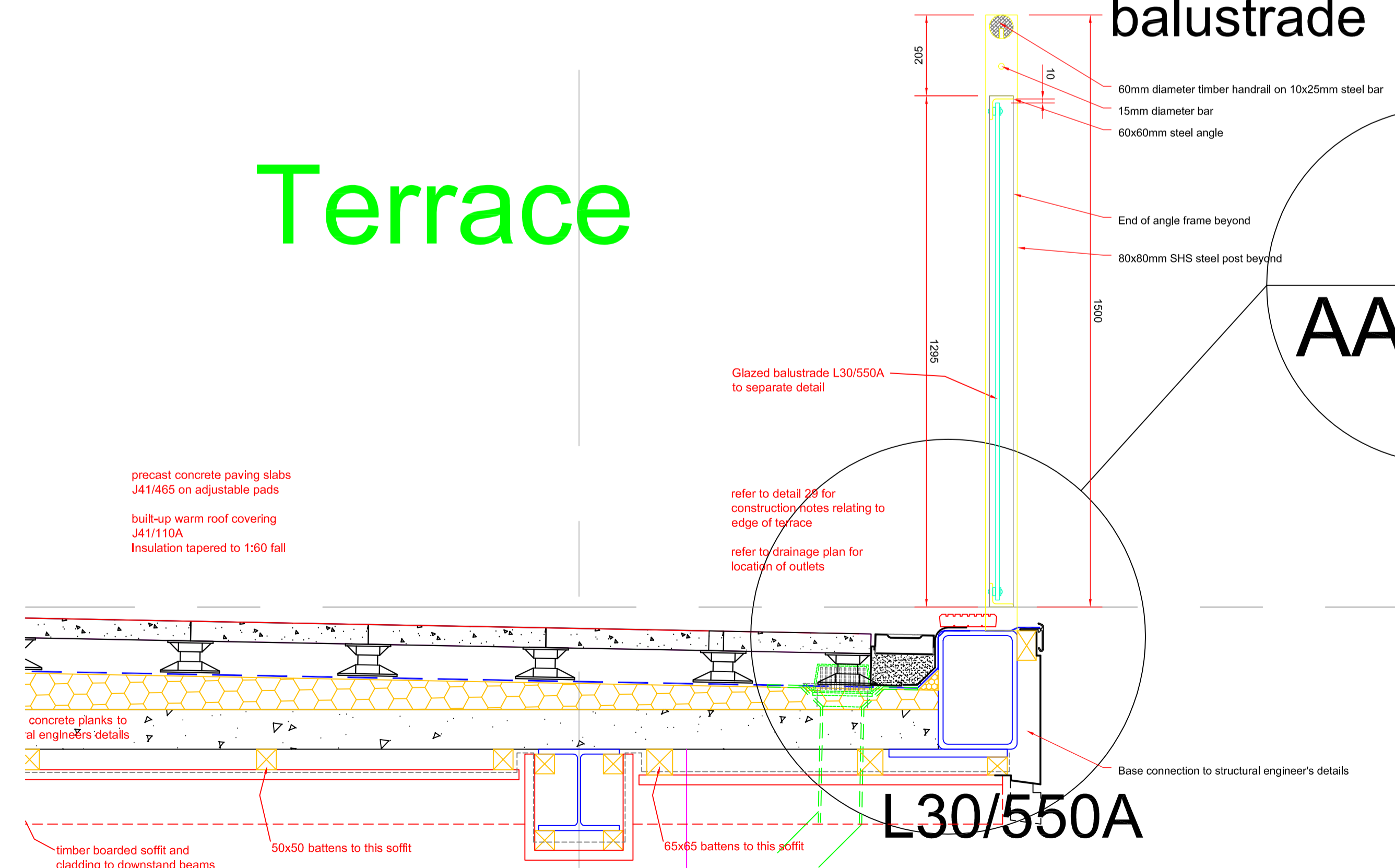

L30/550A

AA(2)99

Design and Project Management Architects Division

2-10 CARBROOK HALL ROAD SHEFFIELD S9 2DB
Tel. 0114 2736036 Fax. 0114 2736299 Email. architects@sheffield.gov.uk

Design & Project Management, Head of Service I G Taylor ARICS

REV	DATE	REVISIONS	DRAWN	CHECKED	NOTES

CLIENT: EDUCATION DIRECTORATE

SCHEME: SHIRECLIFFE

TITLE: PROPOSED ELEVATIONS South & North

STATUS: FOR APPROVAL

SCALE: 1:200

DATE: 12/05

SCHEME NO: ED00747

DWG. NO.: AL (0) 01

Sheffield City Council

Design & Project Management